

## G-102 and G-103 AMX Equipment Instructions

Please press  
Shidler logo  
to begin.



### LIGHTS, PROJECTORS AND SCREENS

The AMX system automatically adjusts the lights, projectors and screens for your use.

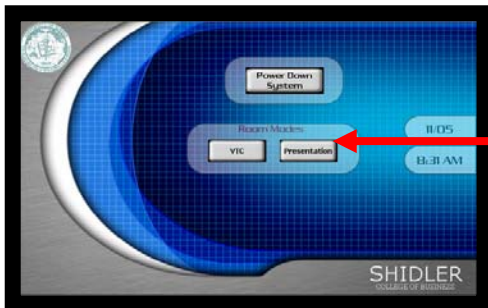

At the main menu, press the  
“Presentation” button.

*Note: “VTC” is for Video Teleconference  
equipment.*

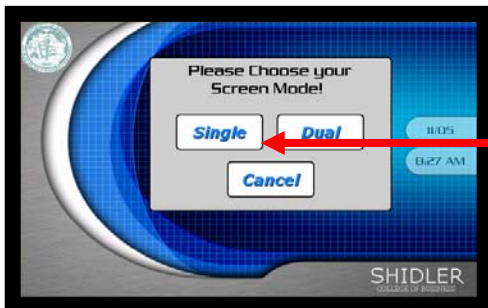

One or two screens can be selected by  
pressing the “Single” or “Dual” button.

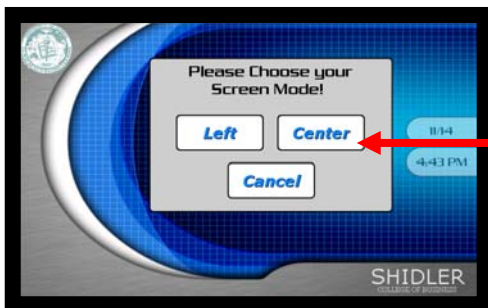

For “Single” screen use, the “Center”  
screen or other screen may be selected.

For more details on controlling screens,  
please go to page 3.

# INPUTS AND OUTPUTS

Press the equipment input button then press the output screen to connect the equipment to the screen.

Local Monitor

Classroom Screens

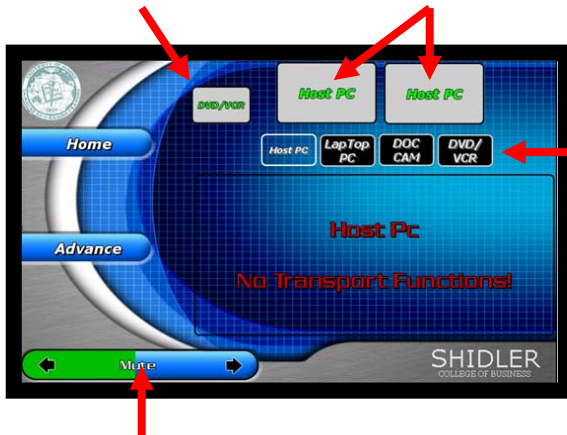

Inputs: Host PC (Page 4)  
LapTop PC (Page 4)  
Doc Cam (Page 5)  
DVD/VCR (Page 6)

Volume Control

---

**Note: Please turn off the projectors and erase the white boards when done.**

---

Press "Home" and then "Power Down System"

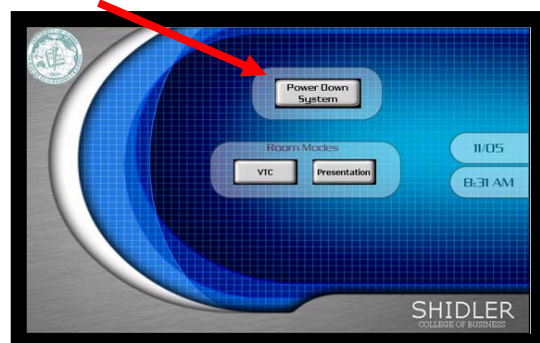
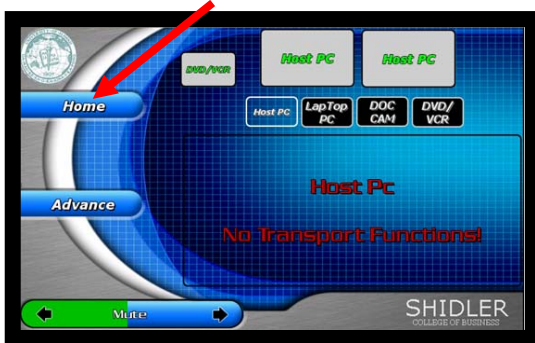

"Yes"



# SCREENS

To change single screens from “Left” to “Center” or vice versa, press the “Home” button then “Presentation” then “Single”

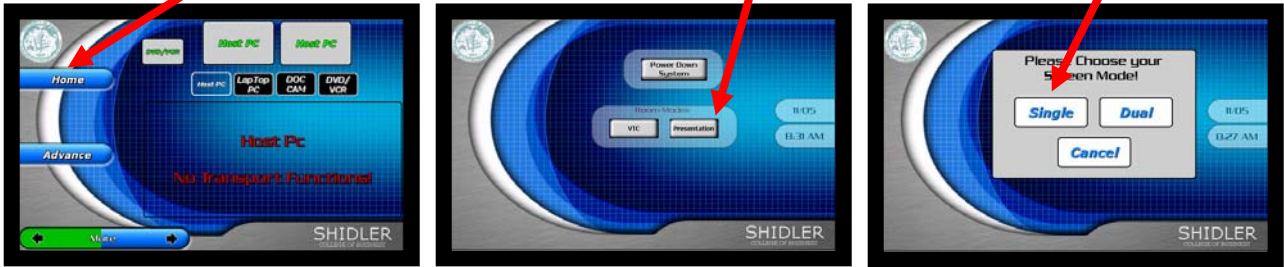

and select screen.



To change two screens from “Dual” to “Single,” press the “Home” button then “Presentation” then “Single.”



and select screen.



To change one screen from “Single” to “Dual,” power down system (Page 2) and start over (Page 1).

## Host PC

The Host PC is in the lectern.



DVD/CD ROM

3.5" Floppy Drive

USB Ports

Power Button

## LapTop PC

A laptop PC can be connected to the projectors using the VGA and audio cables provided.



## Lights

The lighting can be adjusted to different levels by pressing the buttons on the panel on the wall near the lectern.

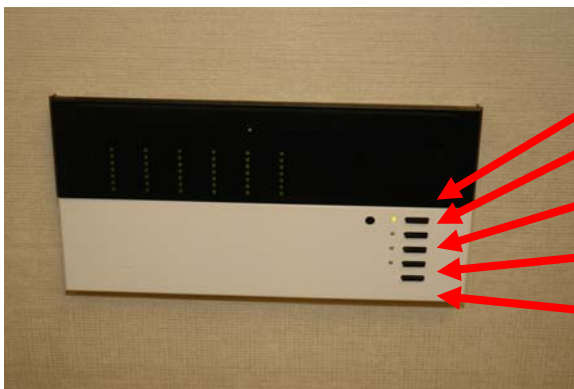

All on

Front off

All dimm

All dimmer

All off

## Doc Cam

When selected, the Document Camera controls will appear on the AMX screen and can be pressed to change settings.

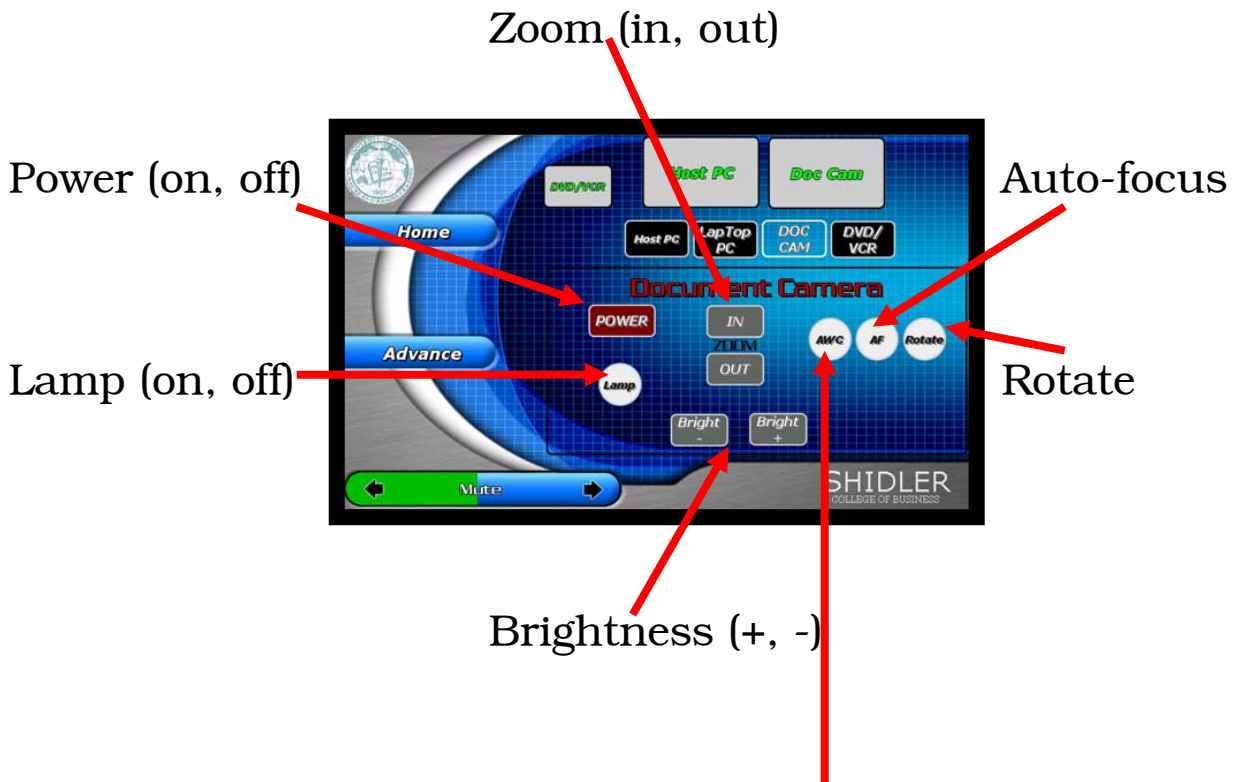

The Auto White Control button is for calibrating the Document Camera color quality. Press the "AWC" button when the image on the document camera is white.

The buttons on the Doc Cam may also be used to change settings.



## DVD/VCR

When selected, the DVD/VCR controls will appear on the AMX screen and can be pressed to change settings.

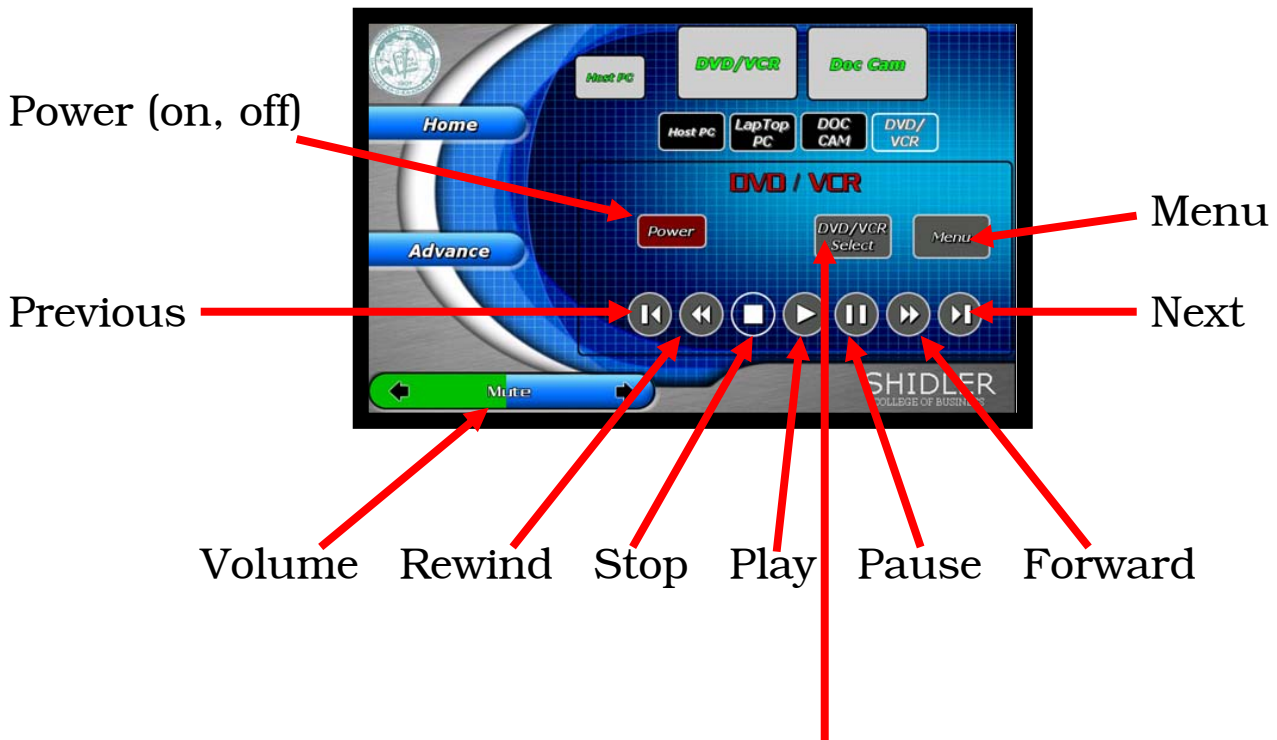

The DVD/VCR Select button is for changing between DVD and VCR modes. Press the "DVD/VCR Select" button to toggle between DVD or VCR.

VCR Indicator light

DVD Indicator Light



The buttons on the DVD/VCR may also be used to change settings.